



3rd Angle Projection  
DO NOT SCALE

## CUTS AVAILABLE ON WINDOW LENGTH (WL) AND WINDOW WIDTH (WW)

NOTE: LAM OVERLAP SPECIFIED RELATES  
TO INNER CORES. OVERLAP IS DOUBLED  
ON OUTER.

SET CUT POSITION AS PERCENTAGE  
OF WW OR WL  
(H05) (M21)

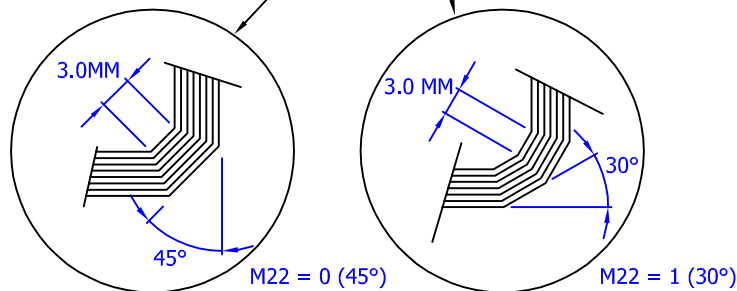
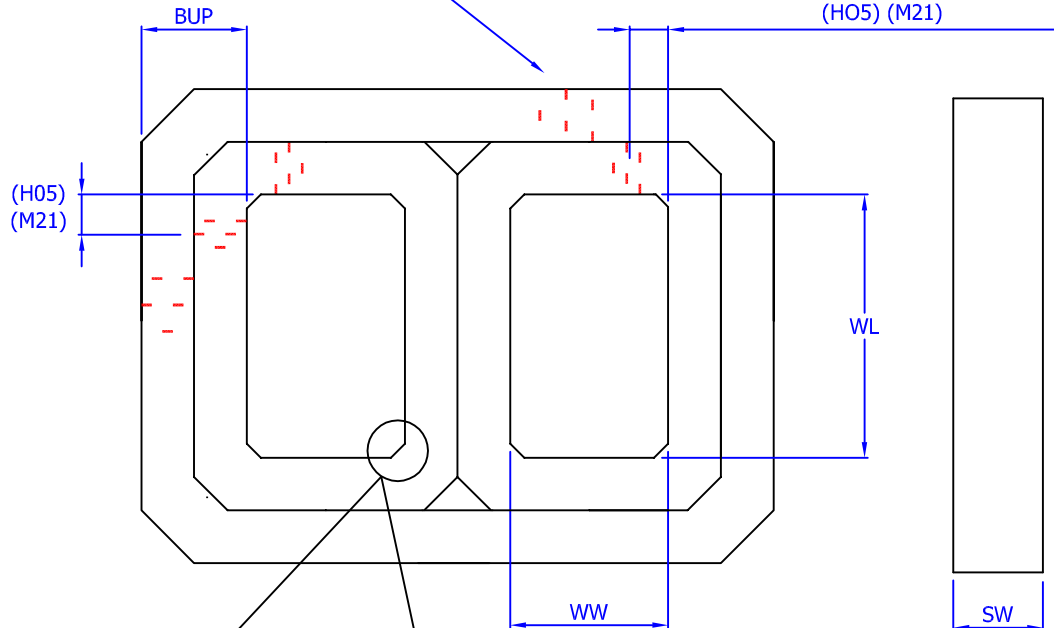

LAMINATION OVERLAP (H20)

NUMBER OF OVERLAPS BEFORE  
REPEAT (H66)

NUMBER OF LAMINATIONS PER  
OVERLAP (H68)

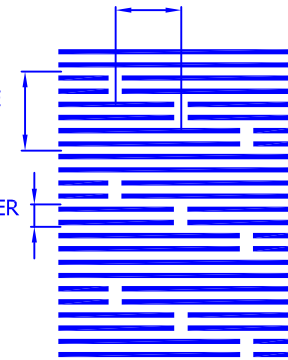

CLOSEUP OF CUT PATTERN  
GAPS DEFAULT TO 0 MICRON WIDE  
SHOWN EXPLODED FOR CLARITY

CORNER RADII  
ARE SET TO 3MM

WL	MM	+ 0.5 - 0.0
WW	MM	+ 0.5 - 0.0
SW	MM	+ 0.5 - 0.0
BU	MM	+ 0.25 - 0.25
M22	0	- CORNER SELECTION 0=45° 1=30°
M21	0	- CUT POSITION WW =0 WL =1
H66	3	- # OVERLAPS BEFORE REPEATING
H68	2	- # LAMINATIONS PER OVERLAP
H20	15000 micron	- INNER CORE OVERLAP LENGTH
H06	DEFAULT = 2	- TIGHTNESS FACTOR
H05	7%	- CUT POSITION AS A PERCENTAGE OF WW OR WL
MTL		

A.E.M. PART# **ECORE7**

**E-CORE UNICORE WITH 30°/45° CORNERS AND  
A ONE CUT DISTRIBUTED GAP FACE**

Title: **3 PHASE 30°/45° DISTRIBUTED GAP FACE UNICORE**

Eng : M. NAVACCHI	Scale:	Drawing File	Assoc Text File	Assoc Program
Date : DEC 2001	No Scale			<b>ECORE7</b>

A.E.M. CORES PTY LTD  
95 BEDFORD ST GILLMAN SA 5013

Phone: 08 8341 0086  
Fax: 08 8341 0225